

CHANNEL BALING PRESSES OF THE SERIES

UPAK®

SPECIFIED PURPOSE

- Waste paper distribution centres with limited amount of material grades
- Cardboard manufacturer
- Shopping centres and warehouses
- Distribution centres
- Printing shops

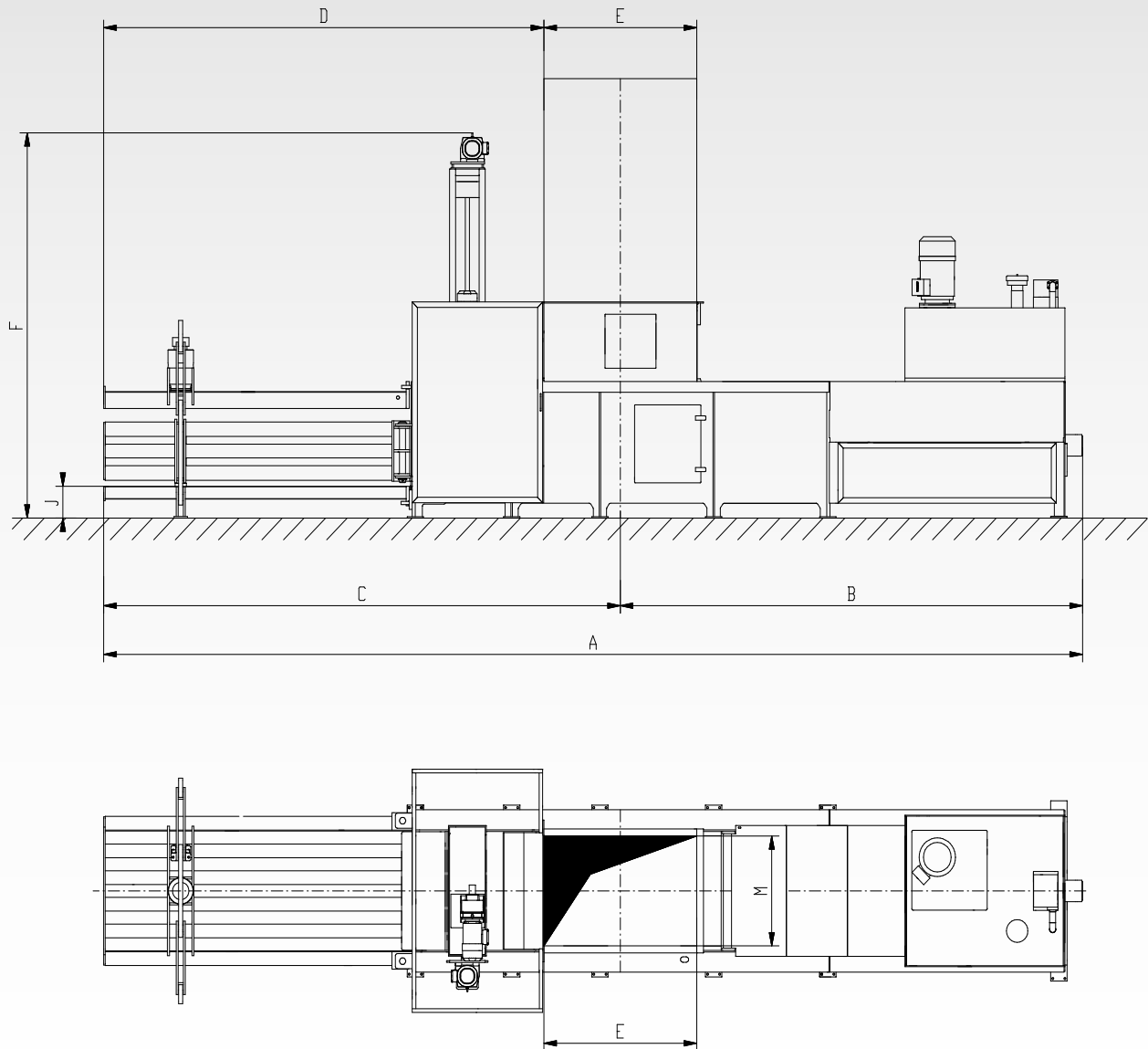
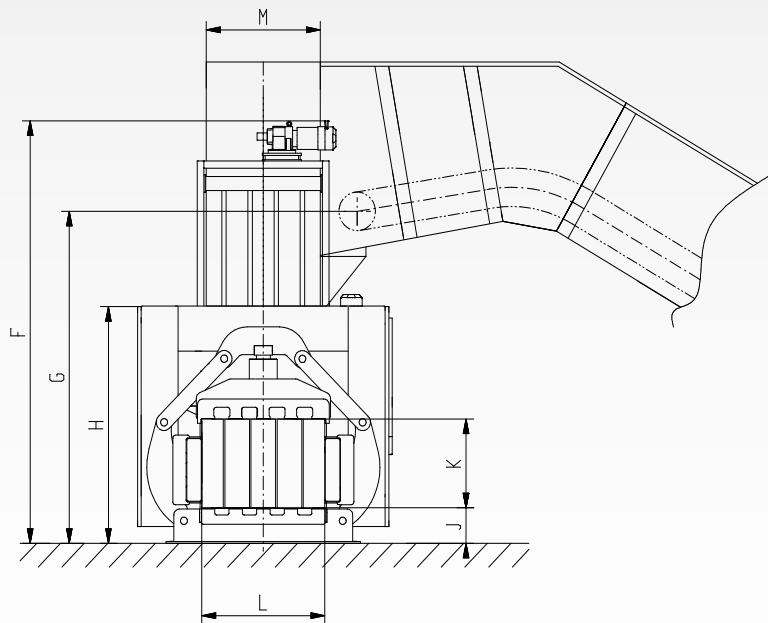

DIMENSIONS	A	B	C	D	E	F	G	H	J	K	L	M
UPAK 60	8.110	4.215	3.895	3.195	1.400	3.670	2.800	2.000	400	750	1.000	920
UPAK 70	9.675	4.610	5.065	4.315	1.500	3.670	2.800	2.000	400	750	1.100	1.020
UPAK 80	10.550	5.250	5.300	4.500	1.600	3.720	2.850	2.000	450	750	1.100	1.020

subject to changes in design and dimensions!

UPAK	60	70	80
Pressing force	630 kN	720 kN	800 kN
Specific pressure	84 N/cm²	87 N/cm²	97 N/cm²
Hopper opening	1.400 x 920 mm	1.500 x 1.020 mm	1.600 x 1.020 mm
Tunnel section (h x w)	750 x 1.000 mm	750 x 1.100 mm	750 x 1.100 mm
Throughput*	1 x 15 kW - 1 x 22 kW - 1 x 30 kW	1 x 22 kW - 1 x 30 kW - 1 x 45 kW	1 x 30 kW - 1 x 45 kW - 1 x 75 kW
20-30 kg/m³	1,8 t/h 3,3 t/h 4,5 t/h	3,4 t/h 4,4 t/h 7,4 t/h	4,2 t/h 6,6 t/h 9,6 t/h
35-50 kg/m³	3,0 t/h 5,5 t/h 7,5 t/h	5,7 t/h 7,2 t/h 12,2 t/h	7,0 t/h 11,0 t/h 16,5 t/h
60 kg/m³	3,6 t/h 6,6 t/h 9,0 t/h	6,9 t/h 8,7 t/h 14,5 t/h	8,4 t/h 13,2 t/h 19,5 t/h
80 kg/m³	3,8 t/h 7,0 t/h 9,6 t/h	7,4 t/h 9,3 t/h 15,5 t/h	8,9 t/h 14,0 t/h 21,0 t/h
Bale weight**	350 - 500 kg	420 - 600 kg	500 - 700 kg
Bale length	up to 1,8 m	up to 1,8 m	up to 1,8 m
Total weight	approx. 8 t	approx. 14,6 t	approx. 24 t

* depending on input density and main drive

**depending on input density and bale length

subject to changes in design and dimensions!

The table shows a selection of the possible drive powers. Other drive configurations possible.



unoTech GmbH • Feldkoppel 17 • 49779 Niederlangen • Germany
Phone: +49 5939 / 94 144 - II • Fax: +49 5939 / 94 144 - 30
info@unotech.de • www.unotech.de



UNOTECH®. INNOVATION DRIVEN BY EXPERIENCE.

UNOTECH®
LM GROUP

Channel baling presses
with vertical steel tying

CHANNEL BALING PRESSES OF THE SERIES

UPAK[®]

UNOTECH[®]
LM GROUP

**MADE IN
GERMANY**
CE



1. AUTOMATIC TYING

- Fully automatic 4-fold vertical tying unit with extreme functional reliability and integrated wire cut with powerful twisting and wire-pull motor
- Suitable for wire thicknesses from 2,8 up to 3,4 mm
- Replacement of twisting hook as a single spare part within shortest terms and without any special tool possible

- User-friendly threading of the lower tying wires
- Optimal accessibility from the side
- Wire unreeling devices for lower wires fully integrated inside the baler therefore no need for additional space

- Large, wide-opening safety door for best accessibility for all regular maintenance and inspection work
- Minimum number of wearing parts

2. POWER PACK

- Compact hydraulic power pack with energy-efficient and noise-optimised main drive
- No additional oil-cooling system required
- Power pack fully integrated into the baler frame

- Integration of all ancillary functions within the main hydraulic block thus avoiding the risk of leakages
- Consideration of all basic legal information regarding water protection

3. OPERATOR PANEL

- Main connection of the baler by an industry-type 5-pole CEE wall-mounted socket-outlet
- Easy and safe operation for hand and automatic mode
- Display of all states for operation and maintenance
- Selection of the desired bale length by selector switches

4. BALER SAFETY

- Modular baler safety system via key transfer system including the prevention of lock-in danger

5. ADDITIONAL EQUIPMENT

- Option for connecting a peripheral hydraulic function such as tipping device

